

& DUERQ 1HXWUDO \$ SR
2NDQDJJDQ & F

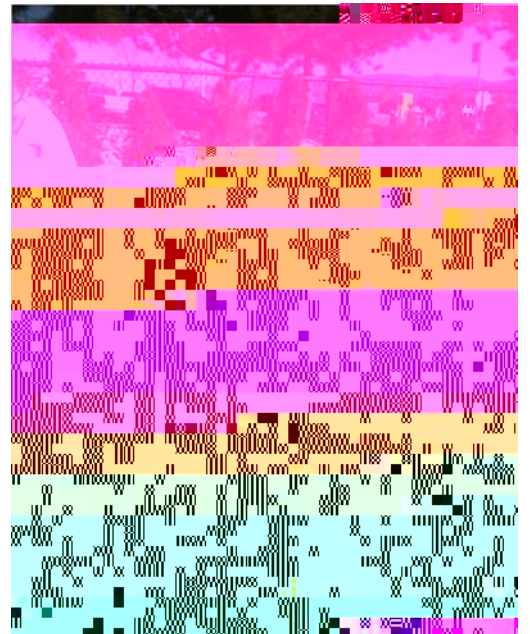
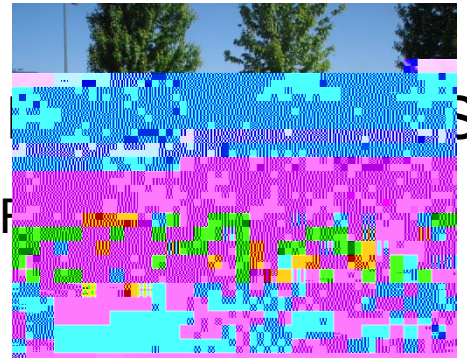
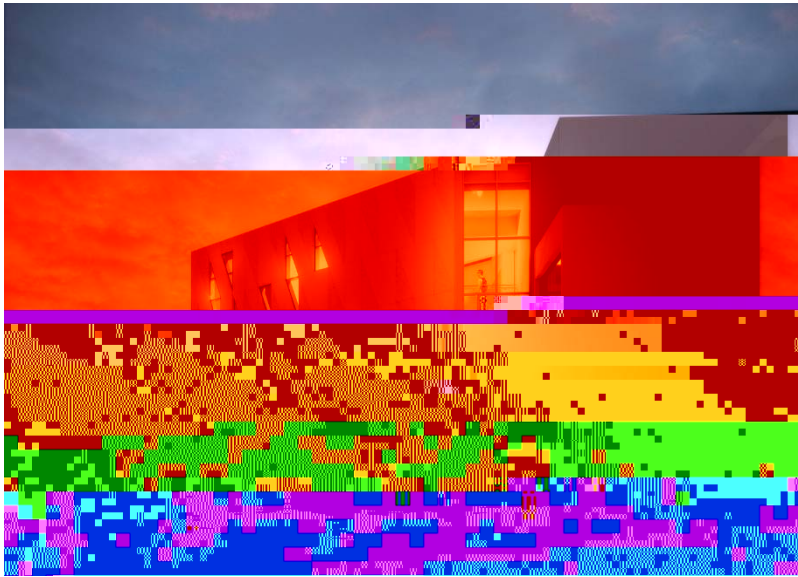

collège

1100

okanagan

collège

98



work and learn from home which in turn yielded tremendous reductions in paper and fleet vehicle usage. Because of remote learning there was reduced heating and ventilation requirements which had a tremendous impact on GHG emissions. There remains opportunities to parley some of the environmental efficiencies provided by the appropriate use of technology.



Other

aging fleet vehicles with electric models to reduce operating costs and GHG emissions as well as provide an opportunity to introduce staff to the 'EV experience'.

Emissions and Offset Summary Table:

Kl v P v }oo P îîûî]••,]}v• v K((• š•	
' , ' u]••]}v• Œ]vš o v Œ z Œ îîîî	
d}š o u]••]}v• ~š K	õìò
d}š o]} K	íXîî
d}š o K((• îš• ~š K	õîñ
iµ•š u v š• š} K((• š Z ‹µ]Œ ' , ' u]••]}z• Œ•%o}Œ š]v W Œ]}Œ	
d}š o K((• š• iµ•š u v š ~š	íõ
'Œ v d}š o KŒ•šž• (îîî Z %o}Œ š]vP z Œ	
'Œ v d}š o K((• šš• ~š Z š (}Œ îîîî Z %o}Œ š]vP z Œ	õîð
K((• š /vÄ •š u v š τ•îñ %o	“îîUîîî

Retirement of Offsets:

collège

1100

okanagan

collège

98